

FEDERAL EMERGENCY MANAGEMENT AGENCY
NATIONAL FLOOD INSURANCE PROGRAM

D.M.B. No. 3067-0077
Expires December 31, 2005

ELEVATION CERTIFICATE

Important: Read the instructions on pages 1 - 7.

| | | | |
|---|-------------|--|--|
| SECTION A - PROPERTY OWNER INFORMATION | | For Insurance Company Use | |
| BUILDING OWNER'S NAME W.L. Moore Construction | | Policy Number | |
| BUILDING STREET ADDRESS (including Apt., Unit, Suite, and/or Bldg. No.) OR P.O. ROUTE AND BOX NO. 518 Griffin Oaks Drive | | Company NAIC Number | |
| CITY Central Point | STATE OR | ZIP CODE 97502 | |
| PROPERTY DESCRIPTION (Lot and Block Numbers, Tax Parcel Number, Legal Description, etc.) Lot 39 Griffin Oaks Unit 2, Phase 1 | | | |
| BUILDING USE (e.g., Residential, Non-residential, Addition, Accessory, etc. Use a Comments area, if necessary.) Residential | | | |
| LATITUDE/LONGITUDE (OPTIONAL) (##°-##'-###" or ###.###") | | HORIZONTAL DATUM: SOURCE: <input type="checkbox"/> GPS (Type): <input type="checkbox"/> NAD 1927 <input type="checkbox"/> NAD 1983 <input type="checkbox"/> USGS Quad Map <input type="checkbox"/> Other: _____ | |

SECTION B - FLOOD INSURANCE RATE MAP (FIRM) INFORMATION

| | | | |
|---|-----------------|---|---|
| B1. NFIP COMMUNITY NAME & COMMUNITY NUMBER Jackson County 415589 | | B2. COUNTY NAME Jackson | B3. STATE Oregon |
| B4. MAP AND PANEL NUMBER 415589-0402 | B5. SUFFIX B | B6. FIRM INDEX DATE 4-11-78 | B7. FIRM PANEL EFFECTIVE/REVISED DATE 4-1-82 |
| B8. FLOOD ZONE(S) A-8 | | B9. BASE FLOOD ELEVATION(S) (Zone AO, use depth of flooding) 1267.5 | |

- B10. Indicate the source of the Base Flood Elevation (BFE) data or base flood depth entered in B9.
 FIS Profile FIRM Community Determined Other (Describe): _____
- B11. Indicate the elevation datum used for the BFE in B9: NGVD 1929 NAVD 1988 Other (Describe): _____
- B12. Is the building located in a Coastal Barrier Resources System (CBRS) area or Otherwise Protected Area (OPA)? Yes No Designation Date _____

SECTION C - BUILDING ELEVATION INFORMATION (SURVEY REQUIRED)

- C1. Building elevations are based on: Construction Drawings* Building Under Construction* Finished Construction
 *A new Elevation Certificate will be required when construction of the building is complete.
- C2. Building Diagram Number 2 (Select the building diagram most similar to the building for which this certificate is being completed - see pages 5 and 7. If no diagram accurately represents the building, provide a sketch or photograph.)
- C3. Elevations - Zones A1-A30, AE, AH, A (with BFE), VE, V1-V30, V (with BFE), AR, AR/A, ARI/AE, ARIA1-A30, ARIA/H, ARIA/O
 Complete items C3.-e) below according to the building diagram specified in item C2. State the datum used. If the datum is different from the datum used for the BFE in Section B, convert the datum to that used for the BFE. Show field measurements and datum conversion calculation. Use the space provided or the Comments area of Section D or Section G, as appropriate, to document the datum conversion.
 Datum 1929 Conversion/Comments N/A
 Elevation reference mark used RM-1 Does the elevation reference mark used appear on the FIRM? Yes No
- o a) Top of bottom floor (including basement or enclosure) 1257. 0 ft.(m)
 - o b) Top of next higher floor 1258. 0 ft.(m)
 - o c) Bottom of lowest horizontal structural member (V zones only) N/A. ft.(m)
 - o d) Attached garage (top of slab) 1257. 8 ft.(m)
 - o e) Lowest elevation of machinery and/or equipment servicing the building (Describe in a Comments area) 1258. 5 ft.(m)
 - o f) Lowest adjacent (finished) grade (LAG) 1257. 0 ft.(m)
 - o g) Highest adjacent (finished) grade (HAG) 1258. 5 ft.(m)
 - o h) No. of permanent openings (flood vents) within 1 ft. above adjacent grade 5
 - o i) Total area of all permanent openings (flood vents) in C3.h 50 sq. in. (sq. cm)

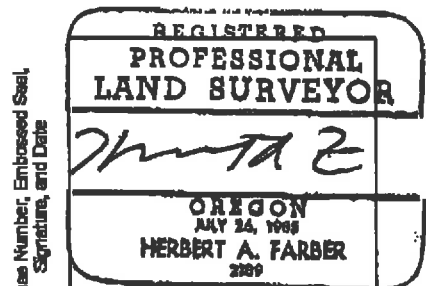

RENEWAL DATE 12-31-2003

SECTION D - SURVEYOR, ENGINEER, OR ARCHITECT CERTIFICATION

This certification is to be signed and sealed by a land surveyor, engineer, or architect authorized by law to certify elevation information.
 I certify that the information in Sections A, B, and C on this certificate represents my best efforts to interpret the data available.
 I understand that any false statement may be punishable by fine or imprisonment under 18 U.S. Code, Section 1001.

| | | | |
|---------------------------------------|---------------------------------|---------------------------|-------------------|
| CERTIFIER'S NAME Herbert A. Farber | | LICENSE NUMBER 2189 | |
| TITLE President | COMPANY NAME Farber & Sons Inc. | | |
| ADDRESS 431 Oak Street | CITY Central Point | STATE OR | ZIP CODE 97502 |
| SIGNATURE <i>Herbert A. Farber</i> | DATE 6-18-03 | TELEPHONE 541-864-5599 | |

| | | | |
|---|-------------|-------------------|----------------------------|
| IMPORTANT: In these spaces, copy the corresponding information from Section A. | | | For Insurance Company Use: |
| BUILDING STREET ADDRESS (including Apt., Unit, Suite, and/or Bldg. No.) OR P.O. ROUTE AND BOX NO. 518 Griffin Oaks Drive | | | Policy Number |
| CITY Central Point | STATE OR | ZIP CODE 97052 | Company NAIC Number |

SECTION D - SURVEYOR, ENGINEER, OR ARCHITECT CERTIFICATION (CONTINUED)

Copy both sides of this Elevation Certificate for (1) community official, (2) insurance agent/company, and (3) building owner.

COMMENTS

C3a HEAT PUMP

G3a DIRT CRAWL SPACE NEXT HIGHEST IS INHABITED FLOOR

Check here if attachments

SECTION E - BUILDING ELEVATION INFORMATION (SURVEY NOT REQUIRED) FOR ZONE AO AND ZONE A (WITHOUT BFE)

For Zone AO and Zone A (without BFE), complete items E1 through E4. If the Elevation Certificate is intended for use as supporting information for a LOMA or LOMR-F, Section C must be completed.

- E1. Building Diagram Number. (Select the building diagram most similar to the building for which this certificate is being completed - see pages 6 and 7. If no diagram accurately represents the building, provide a sketch or photograph.)
- E2. The top of the bottom floor (including basement or enclosure) of the building is ___ ft.(m) ___ in.(cm) above or below (check one) the highest adjacent grade. (Use natural grade, if available.)
- E3. For Building Diagrams 6-8 with openings (see page 7), the next higher floor or elevated floor (elevation b) of the building is ___ ft.(m) ___ in.(cm) above the highest adjacent grade. Complete items C3.h and C3.i on front of form.
- E4. The top of the platform of machinery and/or equipment servicing the building is ___ ft.(m) ___ in.(cm) above or below (check one) the highest adjacent grade. (Use natural grade, if available.)
- E5. For Zone AO only: If no flood depth number is available, is the top of the bottom floor elevated in accordance with the community's floodplain management ordinance?
 Yes No Unknown. The local official must certify this information in Section G.

SECTION F - PROPERTY OWNER (OR OWNER'S REPRESENTATIVE) CERTIFICATION

The property owner or owner's authorized representative who completes Sections A, B, C (Items C3.h and C3.i only), and E for Zone A (without a FEMA-issued or community-issued BFE) or Zone AO must sign here. The statements in Sections A, B, C, and E are correct to the best of my knowledge.

PROPERTY OWNER'S OR OWNER'S AUTHORIZED REPRESENTATIVE'S NAME

| | | | |
|-----------|------|-----------|----------|
| ADDRESS | CITY | STATE | ZIP CODE |
| SIGNATURE | DATE | TELEPHONE | |
| COMMENTS | | | |

Check here if attachments

SECTION G - COMMUNITY INFORMATION (OPTIONAL)

The local official who is authorized by law or ordinance to administer the community's floodplain management ordinance can complete Sections A, B, C (or E), and G of this Elevation Certificate. Complete the applicable item(s) and sign below.

- G1. The information in Section C was taken from other documentation that has been signed and endorsed by a licensed surveyor, engineer, or architect who is authorized by state or local law to certify elevation information. (Indicate the source and date of the elevation data in the Comments area below.)
- G2. A community official completed Section E for a building located in Zone A (without a FEMA-issued or community-issued BFE) or Zone AO.
- G3. The following information (Items G4-G9) is provided for community floodplain management purposes.

| | | |
|--------------------------------|------------------------------------|---|
| G4. PERMIT NUMBER 1302-0523 | G5. DATE PERMIT ISSUED 11-05-02 | G6. DATE CERTIFICATE OF COMPLIANCE/OCCUPANCY ISSUED 06-16-03 |
|--------------------------------|------------------------------------|---|

G7. This permit has been issued for: New Construction Substantial Improvement

G8. Elevation of as-built lowest floor (including basement) of the building is:

1257.0 ft(m)

Date: 126001929

G9. BFE or (in Zone AO) depth of flooding at the building site is:

1257.5 ft(m)

Date: 126001929

| | |
|--------------------------------------|----------------------------|
| LOCAL OFFICIAL'S NAME Matt Samore | TITLE Community Planner |
| COMMUNITY NAME Central Point | TELEPHONE 541-664-3321 |
| SIGNATURE Matt Samore | DATE 06/25/03 |
| COMMENTS | |

First floor is crawlspace.

Check here if attachments