

FEDERAL EMERGENCY MANAGEMENT AGENCY
NATIONAL FLOOD INSURANCE PROGRAM

O.M.B. No. 3067-0077
Expires December 31, 2005

ELEVATION CERTIFICATE

Important: Read the instructions on pages 1 - 7.

SECTION A - PROPERTY OWNER INFORMATION		For Insurance Company Use:
BUILDING OWNER'S NAME <u>MIKE AND ANDREA N. WILSON</u>		Policy Number
BUILDING STREET ADDRESS (including Apt., Unit, Suite, and/or Bldg. No.) OR P.O. ROUTE AND BOX NO. <u>322 DONNA WAY</u>		Company NAIC Number
CITY <u>CENTRAL POINT</u>	STATE <u>OREGON</u>	ZIP CODE <u>97502</u>
PROPERTY DESCRIPTION (Lot and Block Numbers, Tax Parcel Number, Legal Description, etc.) <u>LOT 46 OF BROOKFIELD ESTATES, UNIT NO. 2 / TAX LOT 119 (37 2W 10 BB)</u>		
BUILDING USE (e.g., Residential, Non-residential, Addition, Accessory, etc. Use a Comments area, if necessary.) <u>RESIDENTIAL</u>		
LATITUDE/LONGITUDE (OPTIONAL) (##°-##'-###" or ##.#####)	HORIZONTAL DATUM: <input type="checkbox"/> NAD 1927 <input type="checkbox"/> NAD 1983	SOURCE: <input type="checkbox"/> GPS (Type): <input type="checkbox"/> USGS Quad Map <input type="checkbox"/> Other
<u>N/A</u>		

SECTION B - FLOOD INSURANCE RATE MAP (FIRM) INFORMATION

B1. NFIP COMMUNITY NAME & COMMUNITY NUMBER <u>JACKSON COUNTY 415589 0402 B</u>	B2. COUNTY NAME <u>JACKSON</u>	B3. STATE <u>OREGON</u>
B4. MAP AND PANEL NUMBER <u>415589 0402</u>	B5. SUFFIX <u>B</u>	B6. FIRM INDEX DATE <u>April 11, 1978</u>
B7. FIRM PANEL EFFECTIVE/REVISED DATE <u>April 11, 1982</u>	B8. FLOOD ZONE(S) <u>A</u>	B9. BASE FLOOD ELEVATION(S) (Zone AO, use depth of flooding) <u>1265</u>

B10. Indicate the source of the Base Flood Elevation (BFE) data or base flood depth entered in B9.
 FIS Profile FIRM Community Determined Other (Describe): _____

B11. Indicate the elevation datum used for the BFE in B9: NGVD 1928 NAVD 1988 Other (Describe): _____

B12. Is the building located in a Coastal Barrier Resources System (CBRS) area or Otherwise Protected Area (OPA)? Yes No
 Designation Date: N/A

SECTION C - BUILDING ELEVATION INFORMATION (SURVEY REQUIRED)

C1. Building elevations are based on: Construction Drawings* Building Under Construction* Finished Construction
 *A new Elevation Certificate will be required when construction of the building is complete.

C2. Building Diagram Number 8 (Select the building diagram most similar to the building for which this certificate is being completed - see pages 6 and 7. If no diagram accurately represents the building, provide a sketch or photograph.)

C3. Elevations - Zones A1-A30, AE, AH, A (with BFE), VE, V1-V30, V (with BFE), AR, AR/A, AR/AE, AR/A1-A30, AR/AH, AR/AO
 Complete items C3.a-i below according to the building diagram specified in item C2. State the datum used. If the datum is different from the datum used for the BFE in Section B, convert the datum to that used for the BFE. Show field measurements and datum conversion calculation. Use the space provided or the Comments area of Section D or Section G, as appropriate, to document the datum conversion.
 Datum FIRM Conversion/Comments NONE
 Elevation reference mark used BM-1 Does the elevation reference mark used appear on the FIRM? Yes No

<input type="checkbox"/> a) Top of bottom floor (including basement or enclosure)	<u>(CRAWL) 1267.4</u>	ft. (m)
<input type="checkbox"/> b) Top of next higher floor	<u>1270.0</u>	ft. (m)
<input type="checkbox"/> c) Bottom of lowest horizontal structural member (V zones only)	<u>N/A</u>	ft. (m)
<input type="checkbox"/> d) Attached garage (top of slab)	<u>1268.8</u>	ft. (m)
<input type="checkbox"/> e) Lowest elevation of machinery and/or equipment servicing the building (Describe in a Comments area.)	<u>1269.4</u>	ft. (m)
<input type="checkbox"/> f) Lowest adjacent (finished) grade (LAG)	<u>1268.5</u>	ft. (m)
<input type="checkbox"/> g) Highest adjacent (finished) grade (HAG)	<u>1269.1</u>	ft. (m)
<input type="checkbox"/> h) No. of permanent openings (flood vents) within 1 ft. above adjacent grade	<u>16</u>	
<input type="checkbox"/> i) Total area of all permanent openings (flood vents) in C3.h	<u>1,584</u>	sq. in. (sq. ft.)

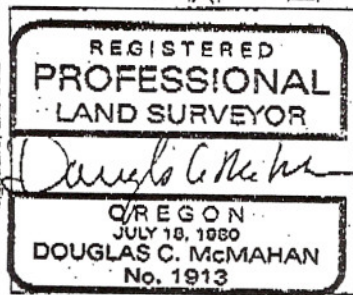

SECTION D - SURVEYOR, ENGINEER, OR ARCHITECT CERTIFICATION RENEWED 12/31/06

This certification is to be signed and sealed by a land surveyor, engineer, or architect authorized by law to certify elevation information.
 I certify that the information in Sections A, B, and C on this certificate represents my best efforts to interpret the data available.
 I understand that any false statement may be punishable by fine or imprisonment under 18 U.S. Code, Section 1001.

CERTIFIER'S NAME DOUGLAS C. McMAHAN LICENSE NUMBER LS 1913

TITLE LAND SURVEYOR COMPANY NAME HOFFBUHR & ASSOC., INC.

ADDRESS 880 GOLF VIEW DRIVE # 201 CITY MEDFORD STATE OREGON ZIP CODE 97504

SIGNATURE Douglas C. Mc Mahan DATE 1/19/06 TELEPHONE (541) 779-4641

5

IMPORTANT: In these spaces, copy the corresponding information from Section A:			For Insurance Company Use:
BUILDING STREET ADDRESS (including Apt., Unit, Suite, and/or Bldg. No.), OR P.O. ROUTE AND BOX NO. 322 DONNA WAY			Policy Number
CITY CENTRAL POINT	STATE OREGON	ZIP CODE 97502	Company NAIC Number

SECTION D - SURVEYOR, ENGINEER, OR ARCHITECT CERTIFICATION (CONTINUED)

Copy both sides of this Elevation Certificate for (1) community official, (2) insurance agent/company, and (3) building owner.

COMMENTS
 BASE FLOOD ELEVATION PROVIDED BY CITY OF
 CENTRAL POINT P.B.R. BROOKFIELD ADOPTED FLOOD STUDY
 BY THORNTON ENGINEERING

Check here if attachments

SECTION E - BUILDING ELEVATION INFORMATION (SURVEY NOT REQUIRED) FOR ZONE AO AND ZONE A (WITHOUT BFE)

For Zone AO and Zone A (without BFE), complete Items E1. through E5. If the Elevation Certificate is intended for use as supporting information for a LOMA or LOMR-F, Section C must be completed.

- E1. Building Diagram Number ____ (Select the building diagram most similar to the building for which this certificate is being completed - see pages 6 and 7. If no diagram accurately represents the building, provide a sketch or photograph.)
- E2. The top of the bottom floor (including basement or enclosure) of the building is ____ ft. (m) ____ in. (cm) ____ above or ____ below (check one) the highest adjacent grade. (Use natural grade, if available.)
- E3. For Building Diagrams 6-8 with openings (see page 7), the next higher floor or elevated floor (elevation b) of the building is ____ ft. (m) ____ in. (cm) above the highest adjacent grade. Complete items C3.h and C3.i on front of form.
- E4. The top of the platform of machinery and/or equipment servicing the building is ____ ft. (m) ____ in. (cm) ____ above or ____ below (check one) the highest adjacent grade. (Use natural grade, if available.)
- E5. For Zone AO only: If no flood depth number is available, is the top of the bottom floor elevated in accordance with the community's floodplain management ordinance? Yes No Unknown. The local official must certify this information in Section G.

SECTION F - PROPERTY OWNER (OR OWNER'S REPRESENTATIVE) CERTIFICATION

The property owner or owner's authorized representative who completes Sections A, B, C (Items C3.h and C3.i only), and E for Zone A (without a FEMA-issued or community-issued BFE) or Zone AO must sign here. The statements in Sections A, B, C, and E are correct to the best of my knowledge.

PROPERTY OWNER'S OR OWNER'S AUTHORIZED REPRESENTATIVE'S NAME _____

ADDRESS _____	CITY _____	STATE _____	ZIP CODE _____
SIGNATURE _____	DATE _____	TELEPHONE _____	
COMMENTS _____			

Check here if attachments

SECTION G - COMMUNITY INFORMATION (OPTIONAL)

The local official who is authorized by law or ordinance to administer the community's floodplain management ordinance can complete Sections A, B, C (or E), and G of this Elevation Certificate. Complete the applicable item(s) and sign below.

- G1. The information in Section C was taken from other documentation that has been signed and embossed by a licensed surveyor, engineer, or architect who is authorized by state or local law to certify elevation information. (Indicate the source and date of the elevation data in the Comments area below.)
- G2. A community official completed Section E for a building located in Zone A (without a FEMA-issued or community-issued BFE) or Zone AO.
- G3. The following information (items G4-G9) is provided for community floodplain management purposes.

G4. PERMIT NUMBER _____	G5. DATE PERMIT ISSUED _____	G6. DATE CERTIFICATE OF COMPLIANCE/OCCUPANCY ISSUED _____
-------------------------	------------------------------	---

- G7. This permit has been issued for: New Construction Substantial Improvement
- G8. Elevation of as-built lowest floor (including basement) of the building is: _____ ft. (m) Datum: _____
- G9. BFE or (in Zone AO) depth of flooding at the building site is: _____ ft. (m) Datum: _____

LOCAL OFFICIAL'S NAME _____	TITLE _____
COMMUNITY NAME _____	TELEPHONE _____
SIGNATURE _____	DATE _____
COMMENTS _____	

Check here if attachments