

ELEVATION CERTIFICATE

Important: Read the instructions on pages 1-9.

OMB No. 1660-0008
 Expiration Date: July 31, 2015

SECTION A - PROPERTY INFORMATION

FOR INSURANCE COMPANY USE
 Policy Number:
 Company NAIC Number:

A1. Building Owner's Name Stehpen and Anne Godshall
 A2. Building Street Address (including Apt., Unit, Suite, and/or Bldg. No.) or P.O. Route and Box No.
 525 Buck Point
 City Central Point State Or ZIP Code 97502

A3. Property Description (Lot and Block Numbers, Tax Parcel Number, Legal Description, etc.)
 372W03BC-800

A4. Building Use (e.g., Residential, Non-Residential, Addition, Accessory, etc.) Residential
 A5. Latitude/Longitude: Lat. 42.3831N Long. 122.9298W Horizontal Datum: NAD 1927 NAD 1983
 A6. Attach at least 2 photographs of the building if the Certificate is being used to obtain flood insurance.
 A7. Building Diagram Number 9
 A8. For a building with a crawspace or enclosure(s):
 a) Square footage of crawspace or enclosure(s) _____ sq ft
 b) Number of permanent flood openings in the crawspace or enclosure(s) within 1.0 foot above adjacent grade _____
 c) Total net area of flood openings in A8.b _____ sq in
 d) Engineered flood openings? Yes No
 A9. For a building with an attached garage:
 a) Square footage of attached garage _____ sq ft
 b) Number of permanent flood openings in the attached garage within 1.0 foot above adjacent grade _____
 c) Total net area of flood openings in A9.b _____ sq in
 d) Engineered flood openings? Yes No

SECTION B - FLOOD INSURANCE RATE MAP (FIRM) INFORMATION

B1. NFIP Community Name & Community Number Jackson County 410092		B2. County Name Jackson		B3. State Or	
B4. Map/Panel Number 41029C1768	B5. Suffix F	B6. FIRM Index Date 05-03-11	B7. FIRM Panel Effective/Revised Date 05-03-11	B8. Flood Zone(s) AE	B9. Base Flood Elevation(s) (Zone AO, use base flood depth) 1246.2

B10. Indicate the source of the Base Flood Elevation (BFE) data or base flood depth entered in Item B9.
 FIS Profile FIRM Community Determined Other/Source: _____
 B11. Indicate elevation datum used for BFE in Item B9: NGVD 1929 NAVD 1988 Other/Source: _____
 B12. Is the building located in a Coastal Barrier Resources System (CBRS) area or Otherwise Protected Area (OPA)? Yes No
 Designation Date: _____ CBRS OPA

SECTION C - BUILDING ELEVATION INFORMATION (SURVEY REQUIRED)

C1. Building elevations are based on: Construction Drawings* Building Under Construction* Finished Construction
 *A new Elevation Certificate will be required when construction of the building is complete.
 C2. Elevations - Zones A1-A30, AE, AH, A (with BFE), VE, V1-V30, V (with BFE), AR, AR/A, AR/AE, AR/A1-A30, AR/AH, AR/AO. Complete Items C2.a-h below according to the building diagram specified in Item A7. In Puerto Rico only, enter meters.
 Benchmark Utilized: RM1 Vertical Datum: NAVD 1988
 Indicate elevation datum used for the elevations in items a) through h) below. NGVD 1929 NAVD 1988 Other/Source: _____
 Datum used for building elevations must be the same as that used for the BFE.

Check the measurement used.

a) Top of bottom floor (including basement, crawspace, or enclosure floor)	<u>1246.0</u>	<input checked="" type="checkbox"/> feet	<input type="checkbox"/> meters
b) Top of the next higher floor	<u>1248.8</u>	<input checked="" type="checkbox"/> feet	<input type="checkbox"/> meters
c) Bottom of the lowest horizontal structural member (V Zones only)	<u>n/a</u>	<input type="checkbox"/> feet	<input type="checkbox"/> meters
d) Attached garage (top of slab)	<u>n/a</u>	<input checked="" type="checkbox"/> feet	<input type="checkbox"/> meters
e) Lowest elevation of machinery or equipment servicing the building (Describe type of equipment and location in Comments)	<u>n/a</u>	<input checked="" type="checkbox"/> feet	<input type="checkbox"/> meters
f) Lowest adjacent (finished) grade next to building (LAG)	<u>n/a</u>	<input checked="" type="checkbox"/> feet	<input type="checkbox"/> meters
g) Highest adjacent (finished) grade next to building (HAG)	<u>n/a</u>	<input checked="" type="checkbox"/> feet	<input type="checkbox"/> meters
h) Lowest adjacent grade at lowest elevation of deck or stairs, including structural support	<u>n/a</u>	<input type="checkbox"/> feet	<input type="checkbox"/> meters

SECTION D - SURVEYOR, ENGINEER, OR ARCHITECT CERTIFICATION

This certification is to be signed and sealed by a land surveyor, engineer, or architect authorized by law to certify elevation information. I certify that the information on this Certificate represents my best efforts to interpret the data available. I understand that any false statement may be punishable by fine or imprisonment under 18 U.S. Code, Section 1001.

Check here if comments are provided on back of form. Were latitude and longitude in Section A provided by a licensed land surveyor? Yes No
 Check here if attachments.

Certifier's Name Herbert A Farber License Number 2189
 Title President Company Name Farber & Sons Inc
 Address 431 Oak City Central Point State Or ZIP Code 97502
 Signature [Signature] Date 02-19-13 Telephone 541-664-5599

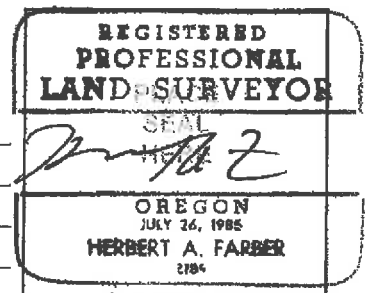

RENEWAL DATE 12-31-13

IMPORTANT: In these spaces, copy the corresponding information from Section A.			FOR INSURANCE COMPANY USE	
Building Street Address (including Apt., Unit, Suite, and/or Bldg. No.) or P.O. Route and Box No. 525 Buck Point			Policy Number:	
City Central Point	State Or	ZIP Code 97502	Company NAIC Number:	

SECTION D – SURVEYOR, ENGINEER, OR ARCHITECT CERTIFICATION (CONTINUED)

Copy both sides of this Elevation Certificate for (1) community official, (2) insurance agent/company, and (3) building owner.

Comments The benchmark is also NGS mark P 549.

Signature *[Signature]* Date 02-19-13

SECTION E – BUILDING ELEVATION INFORMATION (SURVEY NOT REQUIRED) FOR ZONE AO AND ZONE A (WITHOUT BFE)

For Zones AO and A (without BFE), complete Items E1–E5. If the Certificate is intended to support a LOMA or LOMR-F request, complete Sections A, B, and C. For Items E1–E4, use natural grade, if available. Check the measurement used. In Puerto Rico only, enter meters.

- E1. Provide elevation information for the following and check the appropriate boxes to show whether the elevation is above or below the highest adjacent grade (HAG) and the lowest adjacent grade (LAG).
 - a) Top of bottom floor (including basement, crawlspace, or enclosure) is _____ feet meters above or below the HAG.
 - b) Top of bottom floor (including basement, crawlspace, or enclosure) is _____ feet meters above or below the LAG.
- E2. For Building Diagrams 6–9 with permanent flood openings provided in Section A Items 8 and/or 9 (see pages 8–9 of Instructions), the next higher floor (elevation C2.b in the diagrams) of the building is _____ feet meters above or below the HAG.
- E3. Attached garage (top of slab) is _____ feet meters above or below the HAG.
- E4. Top of platform of machinery and/or equipment servicing the building is _____ feet meters above or below the HAG.
- E5. Zone AO only: If no flood depth number is available, is the top of the bottom floor elevated in accordance with the community's floodplain management ordinance? Yes No Unknown. The local official must certify this information in Section G.

SECTION F – PROPERTY OWNER (OR OWNER'S REPRESENTATIVE) CERTIFICATION

The property owner or owner's authorized representative who completes Sections A, B, and E for Zone A (without a FEMA-issued or community-issued BFE) or Zone AO must sign here. The statements in Sections A, B, and E are correct to the best of my knowledge.

Property Owner's or Owner's Authorized Representative's Name _____

Address _____ City _____ State _____ ZIP Code _____

Signature _____ Date _____ Telephone _____

Comments _____

Check here if attachments.

SECTION G – COMMUNITY INFORMATION (OPTIONAL)

The local official who is authorized by law or ordinance to administer the community's floodplain management ordinance can complete Sections A, B, C (or E), and G of this Elevation Certificate. Complete the applicable item(s) and sign below. Check the measurement used in Items G8–G10. In Puerto Rico only, enter meters.

- G1. The information in Section C was taken from other documentation that has been signed and sealed by a licensed surveyor, engineer, or architect who is authorized by law to certify elevation information. (Indicate the source and date of the elevation data in the Comments area below.)
- G2. A community official completed Section E for a building located in Zone A (without a FEMA-issued or community-issued BFE) or Zone AO.
- G3. The following information (Items G4–G10) is provided for community floodplain management purposes.

G4. Permit Number	G5. Date Permit Issued	G6. Date Certificate Of Compliance/Occupancy Issued
-------------------	------------------------	---

- G7. This permit has been issued for: New Construction Substantial Improvement
- G8. Elevation of as-built lowest floor (including basement) of the building: 1248.8 feet meters Datum NAVD88
- G9. BFE or (in Zone AO) depth of flooding at the building site: 1246.2 feet meters Datum NAVD88
- G10. Community's design flood elevation: 1247.2 feet meters Datum NAVD88

Local Official's Name Stephanie Holley, CFM Title Envr. Services Coordinator

Community Name City of Central Point Telephone 541.664.7602, Ext. 244

Signature Stephanie Holley Date 2/22/13

Comments Preliminary (EPC to okay underfloor inspection)

Check here if attachments.