

1 CIVIL SITE PLAN
 C1.0

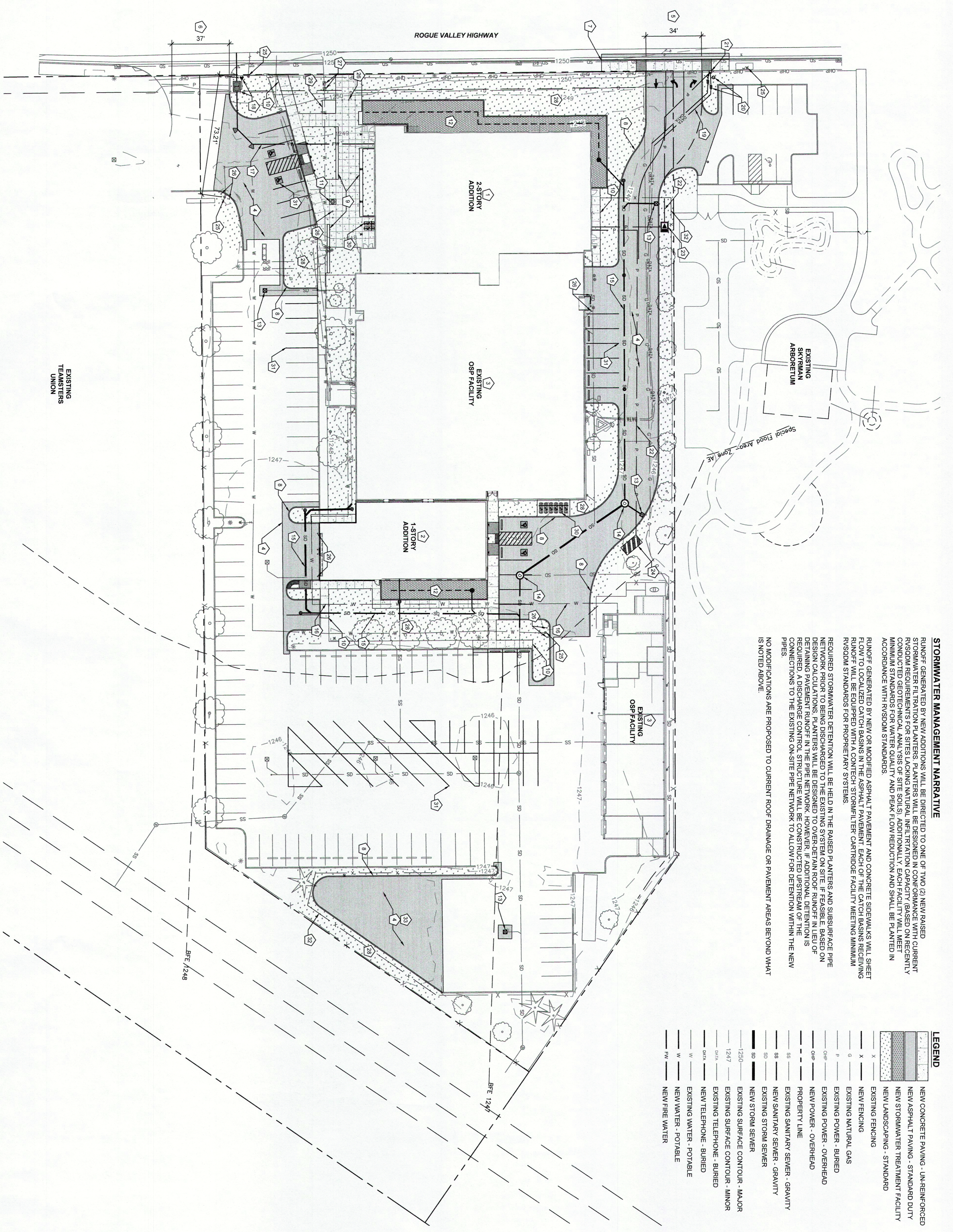

STORMWATER MANAGEMENT NARRATIVE

RUNOFF GENERATED BY NEW ADDITIONS WILL BE DIRECTED TO ONE OF TWO (2) NEW RAISED STORMWATER FILTRATION PLANTERS. PLANTERS WILL BE DESIGNED IN CONFORMANCE WITH CURRENT RVSDOM REQUIREMENTS FOR SITES LACKING NATURAL INFILTRATION CAPACITY (BASED ON RECENTLY MINIMUM STANDARDS FOR WATER QUALITY AND PEAK FLOW REDUCTION) AND SHALL BE PLANTED IN ACCORDANCE WITH RVSDOM STANDARDS.

RUNOFF GENERATED BY NEW OR MODIFIED ASPHALT PAVEMENT AND CONCRETE SIDEWALKS WILL SHEET FLOW TO LOCALIZED CATCH BASINS IN THE ASPHALT PAVEMENT. EACH OF THE CATCH BASINS RECEIVING RUNOFF WILL BE EQUIPPED WITH A CONTECH STORMFILTER CARTRIDGE FACILITY MEETING MINIMUM RVSDOM STANDARDS FOR FROTH/TANK SYSTEMS.

REQUIRED STORMWATER DETENTION WILL BE HELD IN THE RAISED PLANTERS AND SUBSURFACE PIPE NETWORK PRIOR TO BEING DISCHARGED TO THE EXISTING SYSTEM ON SITE. IF FEASIBLE, BASED ON DESIGN CALCULATIONS, PLANTERS WILL BE DESIGNED TO OVER-DRAIN ROOF-RUNOFF IN LIEU OF DETAINING PAVEMENT RUNOFF IN THE PIPE NETWORK. HOWEVER, IF ADDITIONAL DETENTION IS REQUIRED, PLANTERS WILL BE DESIGNED TO PROVIDE DETENTION. DETENTION VOLUMES AND CONNECTIONS TO THE EXISTING ON-SITE PIPE NETWORK TO ALLOW FOR DETENTION WITHIN THE NEW PIPES.

NO MODIFICATIONS ARE PROPOSED TO CURRENT ROOF DRAINAGE OR PAVEMENT AREAS BEYOND WHAT IS NOTED ABOVE.

LEGEND

X	NEW CONCRETE PAVING - JUNE-REINFORCED
X	NEW ASPHALT PAVING - STANDARD DUTY
X	NEW STORMWATER TREATMENT FACILITY
X	NEW LANDSCAPING - STANDARD
X	EXISTING FENCING
X	NEW FENCING
G	EXISTING NATURAL GAS
P	EXISTING POWER - BURIED
OH/P	EXISTING POWER - OVERHEAD
OH/P	NEW POWER - OVERHEAD
---	PROPERTY LINE
SS	EXISTING SANITARY SEWER - GRAVITY
SS	NEW SANITARY SEWER - GRAVITY
SS	EXISTING STORM SEWER
SS	NEW STORM SEWER
1250	EXISTING SURFACE CONTOUR - MAJOR
1247	EXISTING SURFACE CONTOUR - MINOR
SW	EXISTING TELEPHONE - BURIED
SW	NEW TELEPHONE - BURIED
W	EXISTING WATER - POTABLE
W	NEW WATER - POTABLE
FW	NEW FIRE WATER

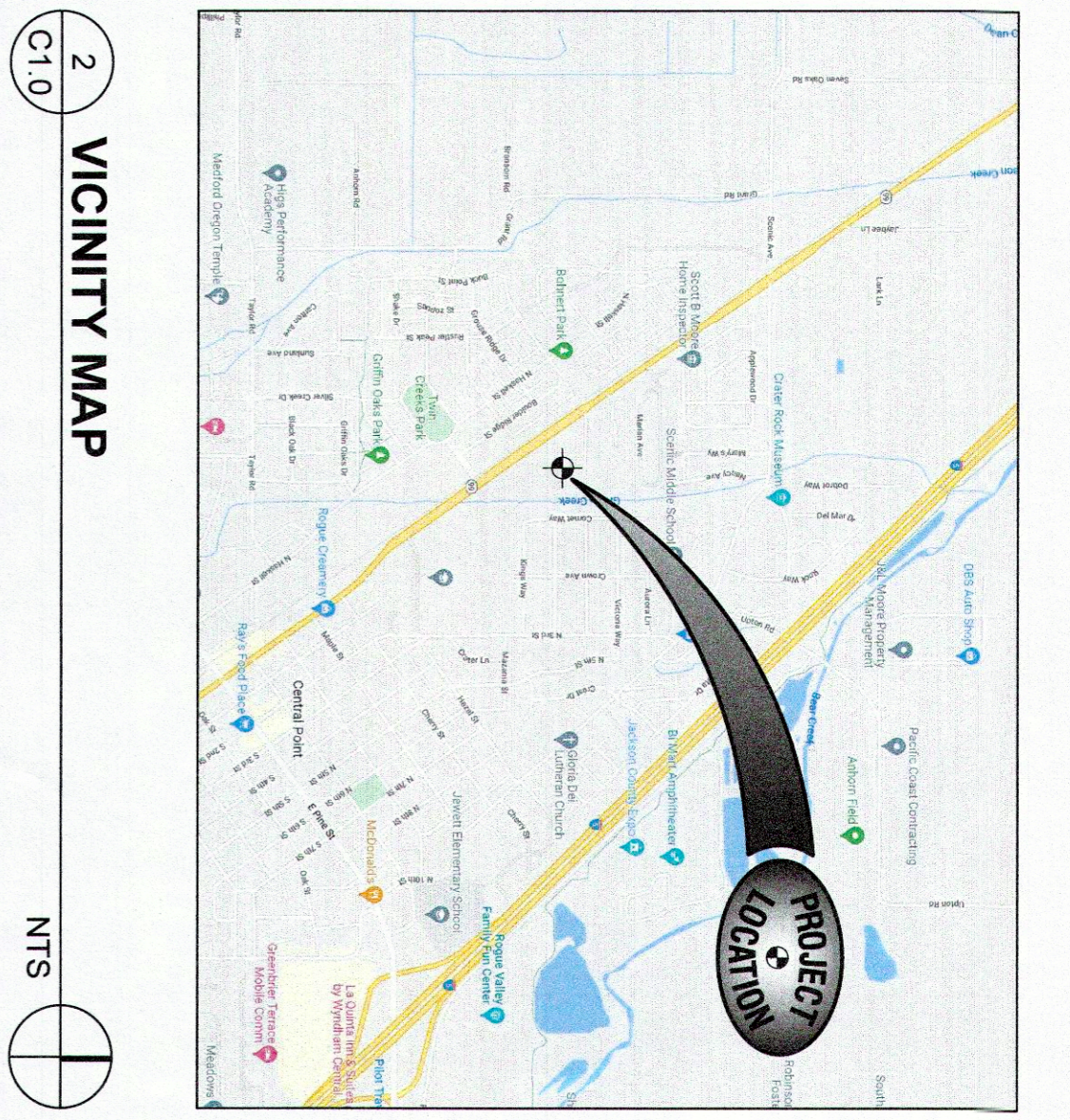

GENERAL INFORMATION

OWNER: OREGON STATE POLICE (OSP)
 4500 ROGUE VALLEY HIGHWAY
 CENTRAL POINT, OR 97502

ENGINEER: SYLVE ALLEN, PE
 CONTACT: MALIKA WATERS
 ZCS ENGINEERING & ARCHITECTURE
 45 HAWTHORNE STREET
 MEDFORD, OREGON 97504
 (941) 500-8888

SITE LOCATION: 4500 ROGUE VALLEY HIGHWAY
 CENTRAL POINT, OREGON 97502
 T37S-R02W-S03BD SE 14 NW 1/4

TAX LOT/SIZE: 900 / 43.57 ACRES

ZONING: TOD - EMPLOYMENT COMMERCIAL

- KEYED NOTES:**
- PROPOSED 2-STORY ADDITION
 - PROPOSED SINGLE STORY ADDITION
 - EXISTING BUILDING TO REMAIN
 - NEW OR MODIFIED ASPHALT PAVEMENT
 - NEW SHARED ACCESS DRIVEWAY APPROACH WITH DEDICATED LEFT TURN LANE
 - EXISTING SHARED ACCESS DRIVEWAY APPROACH TO REMAIN
 - REPLACEMENT OF PUBLIC SIDEWALK WITH CURB, GUTTER, AND ASPHALT
 - NEW CONCRETE CURB
 - NEW 18" TALL CONCRETE SEATWALL
 - NEW CONCRETE SIDEWALK
 - NEW FLAGPOLE
 - NEW RAISED STORMWATER FILTRATION PLANTER WITH PERFORATED UNDER DRAIN CARTRIDGE CONFIGURATION IN CONFORMANCE WITH CURRENT RVSS STANDARDS ASSUMED.
 - NEW CONTECH STORMFILTER CATCH BASIN AND STORMWATER TREATMENT
 - NEW 48" PRE-CAST CONCRETE STORM DRAIN MANHOLE
 - NEW STORM PIPE, SIZE VARIES
 - REROUTED DOMESTIC WATER SERVICE
 - NEW FIRE WATER SERVICE
 - NEW FIRE DEPARTMENT CONNECTION AND DOUBLE CHECK ASSEMBLY VALVE IN WALL.
 - REROUTED DATA SERVICES
 - RELOCATED DATA VALVETRISER
 - RELOCATED OVERHEAD TRANSMISSION POWER LINES, UTILITY POLE AND GUY LINE
 - NEW BURIED POWER SERVICES
 - NEW POWER TRANSFORMER
 - NEW GENERATOR
 - EXISTING FIRE HYDRANT
 - NEW BOLLARD PROTECTION, TYPICAL
 - EXISTING WATER METER AND BACKFLOW DEVICE
 - LANDSCAPE PLANTER, TYPICAL
 - SPACE DEDICATED FOR PUBLIC ART, SEE LANDSCAPE
 - NEW BICYCLE PARKING
 - NEW OR MODIFIED PAVEMENT MARKINGS TO DELINEATE PARKING AREAS, TYPICAL
 - NEW 6" TALL SECURITY FENCING WITH AUTOMATED GATES, REFER TO ARCHITECTURAL PLANS
 - NEW PAVEMENT AREA FOR STORAGE OF EVIDENCE VEHICLES

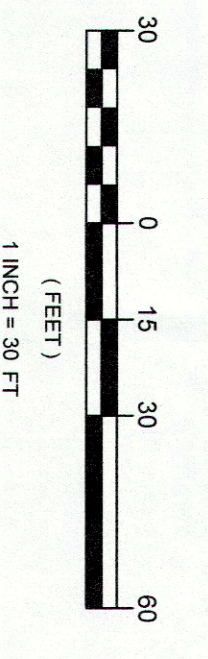

1"=30'

THIS INFORMATION IS CONCEPTUAL IN NATURE AND IS NOT TO BE USED FOR CONSTRUCTION. NO WARRANTIES OR GUARANTEES OF ANY KIND ARE GIVEN OR IMPLIED BY THE ARCHITECT.